

Specifications

- Voltage rating: 250V AC, DC
- Current Rating: 2A, AC, DC
- Withstand voltage: 800V AC/minute
- Contact resistance: 20mΩ max
- Insulation resistance: 1000mΩ min
- Temperature range: -25°C ~ +85°C
- Compliant with RoHS and REACH
- Contact JVT for details

Standards



Assembly layout

JVT2036H

2.0mm Pitch housing

HOUSING

Material: PA66 UL94V-0

Mates With Part(s): JVT2036 Terminal

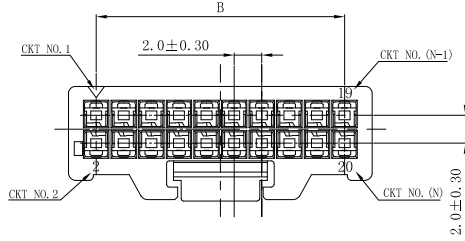

JVT2036HNO-2*XX
 Logo
 系列码
 胶壳
 NO-PA66 UL94V-0
 PIN数

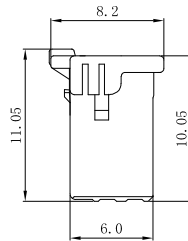
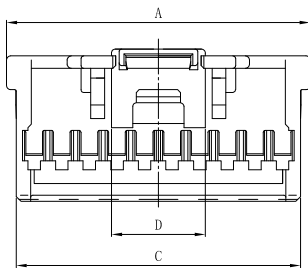

CIRCUITS	DIM. A	DIM. B	DIM. C	DIM. D
5	12	8	10.6	5.1
6	14	10	12.6	6.8
7	16	12	14.6	
8	18	14	16.6	
9	20	16	18.6	
10	22	18	20.6	
11	24	20	22.6	
12	26	22	24.6	
13	28	24	26.6	
14	30	26	28.6	
15	32	28	30.6	
16	34	30	32.6	
17	36	32	34.6	
18	38	34	36.6	
19	40	36	38.6	
20	42	38	40.6	

JVT2036T

2.0mm Pitch Crimp Terminal

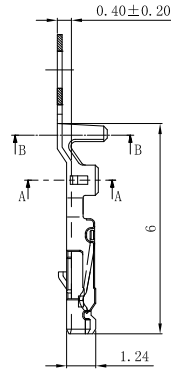
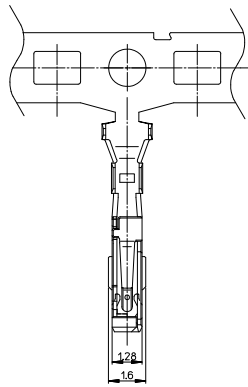

JVT2036TP-SNS
 Logo
 系列码
 端子
 P-磷铜
 S-先冲后镀
 镀锡

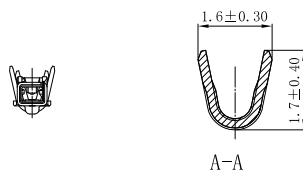

JVT2036TP-SNS	Phos Bronze	Tin Plated	AWG#22~26	1.4mm(Max)	JVT2036 HOUSING
PART NO	Material	Finish(Pin)	Wire Range	Insulation O.D.	Mates With Part(s)

JVT2036W

2.0mm Pitch 90°Wafer-DIP TYPE

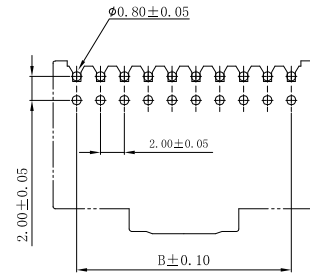
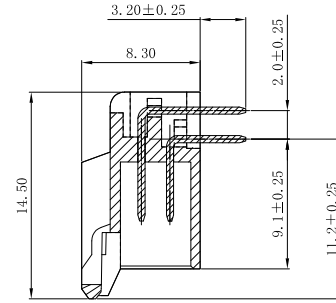
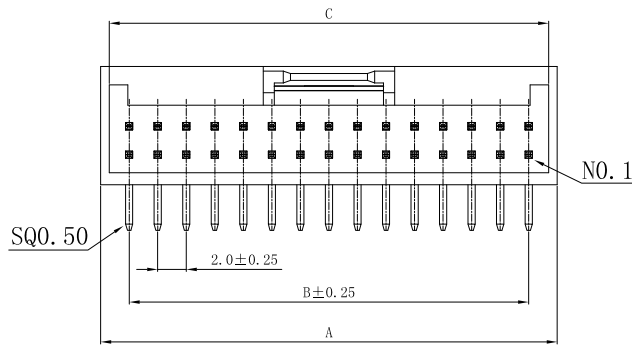
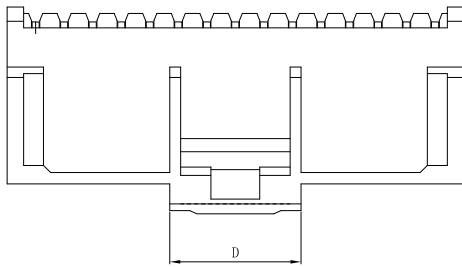
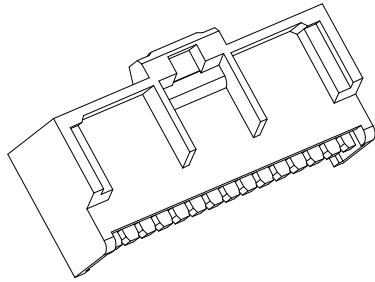

RECOMMENDED PCB
 HOLE DIMENSION
 (MOUNTING SIDE)
 (T=1.2~1.6)

CIRCUITS	DIM. A	DIM. B	DIM. C	DIM. D
5	12	8	10.6	7.3
6	14	10	12.6	
7	16	12	14.6	
8	18	14	16.6	
9	20	16	18.6	
10	22	18	20.6	
11	24	20	22.6	
12	26	22	24.6	
13	28	24	26.6	
14	30	26	28.6	
15	32	28	30.6	
16	34	30	32.6	
17	36	32	34.6	
18	38	34	36.6	
19	40	36	38.6	
20	42	38	40.6	

JVT2036WXX-2*XXSNR-D
 Logo 系列码
 WAFER 系列码
 NO-PA66 UL94V-0
 6T-PA6T UL94V-0
 LP-LCP UL94V-0
 DIP R-90°
 镀锡
 PIN数

JVT2036WLP-2*XXSNR-D	LCP UL94V-0	Brass	Tin Plated	JVT2038 Housing
JVT2036W6T-2*XXSNR-D	PA6T UL94V-0			
JVT2036WN0-2*XXSNR-D	PA66 UL94V-0			
PART NO	Material	Material(Pin)	Finish(Pin)	Mates With Part(s)